

## Smart Cable

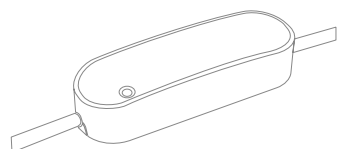

### INSTALLATION MANUAL

Version 1.5

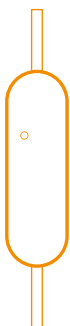

#### Product description

Develco Products' Smart Cable converts power cables to remotely controlled units, that also monitor the power consumption.

The Smart Cable can be used, where there is no space for a smart plug or where a higher load (up to 16 Amp) is required. The Smart Cable has a flexible cable connection and is not dependent on the plug type.

#### Precautions

- Be careful that no liquid gets into the smart cable since it may damage the equipment.
- Do not remove the product label as it contains important information.
- Avoid switching maximum loads frequently on or off, in order to sustain a long life for the smart cable.

#### Getting started

1. Unscrew the inner four screws on the back of the device.
2. Open the casing by pushing the fastening on both sides with a flathead screwdriver.

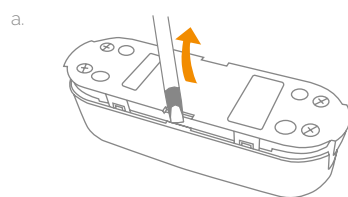

3. Cut your cord in half with wire strippers, remove about 25 mm of the insulation from both ends of the cable freeing the three wires. Remove about 5 mm of the insulation from these three wires on both ends of the cable.
4. Run the exposed cable underneath the clamps and insert the correct wires into the correct ports (Live to Live, Ground to Ground, Neutral to Neutral). Secure the wires by tightening the screws.

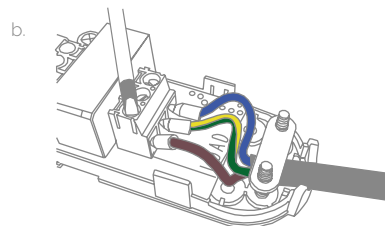

5. Attach the cable running to the appliance to the "LOAD" ports and the end which runs to the outlet into the "IN" ports)

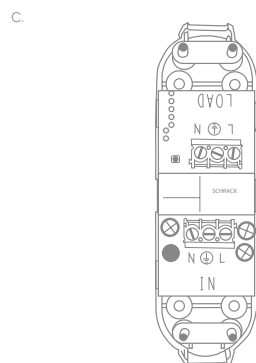

6. With the wires secured, tighten the screws of the cable clamps to secure the cable.

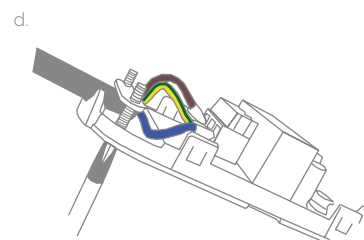

7. Replace the top of the device and tighten in the four inner screws to close the casing.
8. Ensure that the cables are securely fastened.
9. Connect the Smart Cable to the power outlet.
10. The Smart Cable will start searching (up to 15 minutes) for a Zigbee network to join.
11. Make sure that the Zigbee network is open for joining devices and will accept the Smart Cable.
12. While searching for a network, the red LED is flashing every second.



13. The Smart Cable's output is active when the green LED is on.



#### Placement

- Place the smart cable indoors at a temperature between 0-50°C.
- If the device is used as signal amplifier, please position the device in between the gateway and other connected devices.

#### Different Cable Sizes

Adjusting the cable fitting for different size cables is quick and easy. If the opening is not big enough for your cable, simply grab and remove the slide to allow for a larger cable.

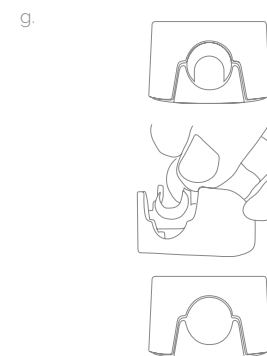

#### Resetting

Resetting is needed if you want to connect your Smart Cable to another gateway, if you need to perform a factory reset to remove abnormal behaviour, or if you need to reset accumulative registers and logs.

#### STEPS FOR RESETTING

1. Connect the Smart Cable to the power outlet.
2. Press and hold down the button on the device.
3. Hold the button down until the red LED flashes continuously, then release the button.

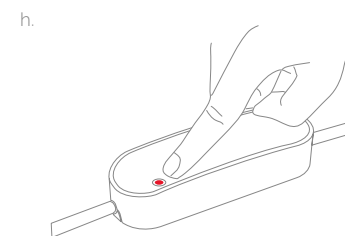

4. After releasing the button, the red LED will stay on for 2-5 seconds. During that time, the device must not be switched off or unplugged.

#### Modes

##### SEARCHING GATEWAY MODE

The red LED is flashing every second

##### ON MODE

Green LED means that the smart cable output is active (relay is on). The relay can be switched on and off by pushing the button.

##### OFF MODE

When there is no light in the LED, the Smart Cable output is inactive.

#### Fault finding

- In case of a bad or weak signal, change the location of the Smart Cable or your gateway.
- If the search for a gateway has timed out, a short press on the LED button will restart it.

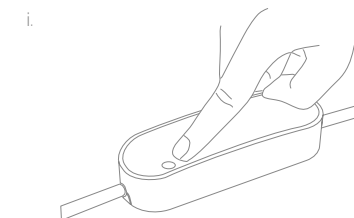

#### Other information

- The Smart Cable will automatically switch off if the load exceeds 16 A or the internal temperature gets too high.
- In case of power failure, the device will restore itself to the on/off status it had before the power failure.

#### Disposal

Dispose the product properly at the end of life. This is electronic waste which should be recycled.

## CE certification

The CE mark affixed to this product confirms its compliance with the European Directives which apply to the product and, in particular, its compliance with the harmonized standards and specifications.



## IN ACCORDANCE WITH THE DIRECTIVES

- Radio Equipment Directive (RED) 2014/53/EU
- Low Voltage Directive (2014/35/EU)
- EMC Directive 2014/30/EU
- RoHS Directive 2015/863/EU amending 2011/65/EU

## Other certifications

- Zigbee Home Automation 1.2 certified



## All rights reserved.

Develco Products assumes no responsibility for any errors, which may appear in this manual. Furthermore, Develco Products reserves the right to alter the hardware, software, and/or specifications detailed herein at any time without notice, and Develco Products does not make any commitment to update the information contained herein. All the trademarks listed herein are owned by their respective owners.

Distributed by Develco Products A/S  
Tangen 6  
8200 Aarhus N  
Denmark  
[www.develcoproducts.com](http://www.develcoproducts.com)

